

FERMAX

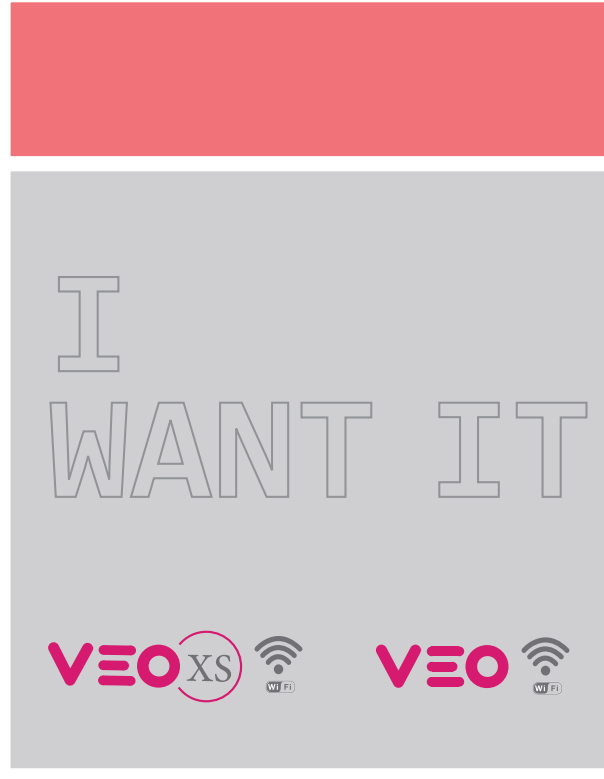

The VEO and VEO-XS monitors with DUOX technology from FERMAX now with WiFi CONNECTIVITY integrated into the monitor. Enjoy the benefits of high tech equipment in your everyday life!

With the new **DUOX WiFi** monitors you can now divert a call from your video door entry system to your smartphone or tablet. You can receive the call, answer it and open the door. All you need is a **DUOX VEO** or **VEO-XS WiFi monitor** installed in the house, then download the free **BLUE** app and pair it to your mobile device. Comfortable and easy communication, whether you are at home or not.

Discover the new features built into the DUOX WiFi monitors. Its connectivity and synchronization with our **BLUE** app will allow you to experience some of the advantages of having call divert in your home.

We assure you **the more you experience them, the more you will want them.**



Smartphone / Tablet



VEO by FERMAX 

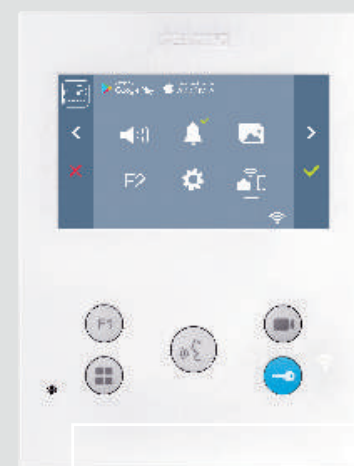

VEOXS by FERMAX 



ANSWER YOUR VIDEO
DOOR ENTRY SYSTEM
CALLS FROM YOUR
SMARTPHONE?



VEO
by PERMAX



I WANT IT

You're going on a trip and you may worry that someone will call at your home and, after receiving no answer, will decide to break into your house.

With the VEO WiFi DUOX and VEO-XS WiFi DUOX monitors, you can answer the call from your mobile phone or tablet.

That way your house will never seem empty. Now you can stop worrying and enjoy your trip.

I WANT IT

You're expecting an important delivery and you won't be home. When it arrives, **you can open the door and the courier can leave it in your mailbox or at the entrance.**

If you want us to tell you about it in a video, scan this code >



OPENING
MY FRONT DOOR
WITH MY MOBILE
PHONE?

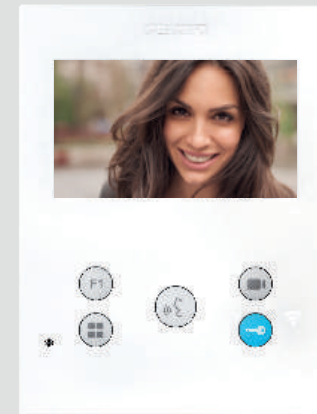

VEOXS
by PERMAX



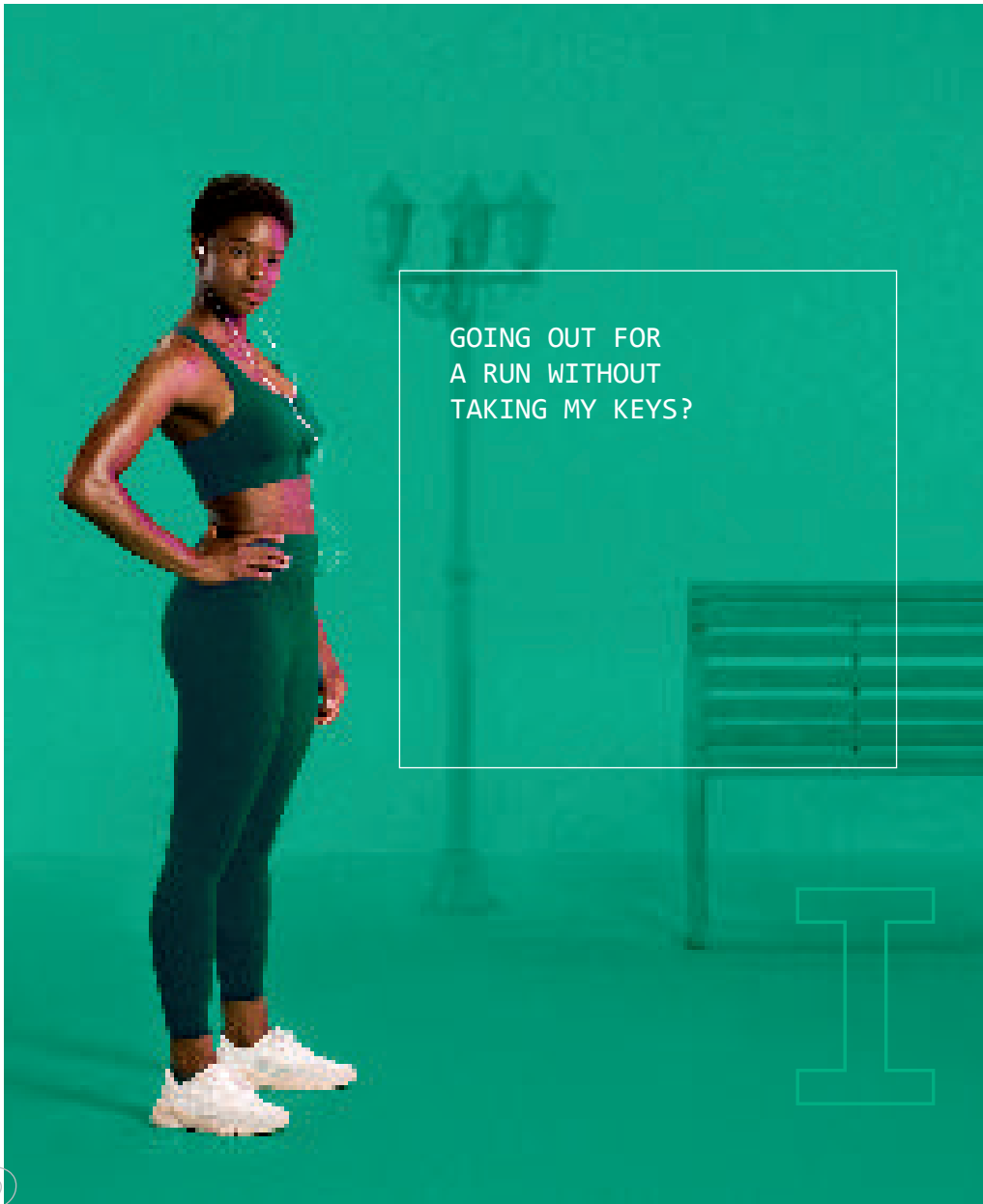

GOING OUT FOR
A RUN WITHOUT
TAKING MY KEYS?



You go for a run, you take your mobile phone but you **don't want to carry your keys with you.** Now you don't need to.

WANT



Or it's simply not convenient for you to get up.

You can't imagine how practical it can be to open your door from your mobile device. Or maybe you can.

IT

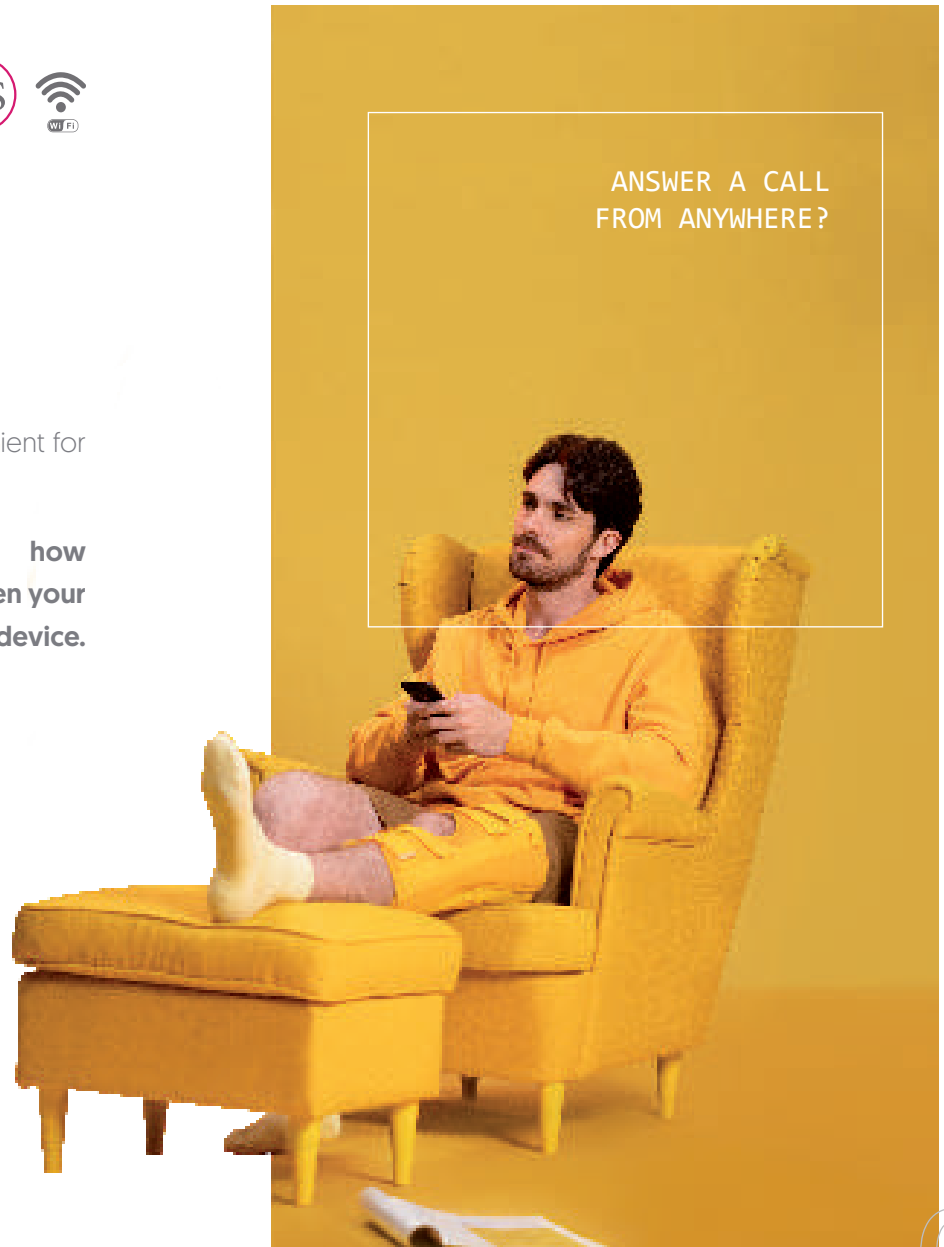



The Monitors

The DUOX VEO and VEO-XS WiFi monitors are made from high-impact ABS plastic. They incorporate a 4.3" [16:9] colour wide screen.

VEO includes a unique and exclusive handset design, comprising a magnet which makes it easier to hang up the phone correctly at the end of the conversation.

VEO-XS is the hands-free version of VEO.

Both monitors are surface mounted.

DUOX WiFi monitors are equipped with a WiFi connection that allows calls to be forwarded to mobile devices. Thanks to Fermax's **BLUE app**, you can manage your video door entry system functions directly from a smartphone or tablet, so you can connect to your home, wherever you are.

Operation

When a call is received, the image appears automatically. Once the call is answered you can begin talking to the visitor. The image disappears automatically after 90 seconds, or when the handset is hung up or the communication is cut off. To open the door, press the lock release button.

Call Divert Functionality

By connecting to the home WiFi network, DUOX WiFi monitors allow the call to be diverted from the video door entry system to a mobile phone or tablet. This provides more security, comfort and mobility to the homeowner, so it will be like you are at home!



Basic Functions

- F1** **Activation of pre-configured additional function:**
Lights on, alarm activation, panic button.
◀ Go back to the previous option from the menu.
- Auto-on. Camera and panel switching.**
▶ Go to the next option in the menu.
- OSD menu, access advanced functions.**
✖ Return to the previous screen or stand-by.
- Lock release button.**
✔ Confirm the selection and activate the function.
- Activate / deactivate communication.**
Only in VEO-XS model.

Advanced Functions

- Automatic capture of images with the call.
- Ringtone selection and call volume adjustment.
- "Do not disturb" mode.
- F1** Additional function F1.
- F2** Additional function F2.
- User's configuration menu.
- Pairing with WiFi network.

WHEN YOU PRESS
THE BLUE ICON ON
YOUR MOBILE DEVICE,
IT'LL BE LIKE
"BEING AT HOME"



Call Divert with the BLUE app

The benefit of using DUOX WiFi monitors that changes everything is that it enables you to **receive calls from your video door entry system on your smartphone or tablet.**

All you need is a DUOX WiFi monitor installed in your home, then download the free **BLUE** application and you will feel just like you are at home.

By pairing your DUOX WiFi monitors with the BLUE app a whole range of possibilities will be opened up to you. Of all of these possibilities, the following two are key: **Divert video door entry system calls to your mobile device and open the door remotely.**







Menu and Features of the BLUE App



Receiving / Answering calls

Conversation. Conversation action buttons:

-  Mute. So the visitor cannot hear us from the outdoor panel.
-  Video off. Only audio. To reduce data usage in 4G mode.
-  Outdoor panel or camera switching.
- F1** Additional function activation protected by the unlocking system from the mobile phone: PIN, fingerprint, pattern or face recognition.
-  Door lock release. Protected by an unlocking system from the mobile phone: PIN, fingerprint, pattern or face recognition.
-  End of conversation.



Door lock release.



Auto-on. Camera and panel switching.



Call the concierge.



F1 additional function.



Call history.



Home settings.



Home WiFi network pairing. Several smartphones or tablets connected to the same home (up to 10). Maximum number of users paired to the same home: Admin + 5 guests (total 6)



Management of several homes from the same application (no limit) / **Start.**

Pairing Process

Pairing the video door entry system with your mobile device is very simple and intuitive.

Let the BLUE app guide you and just follow these steps:

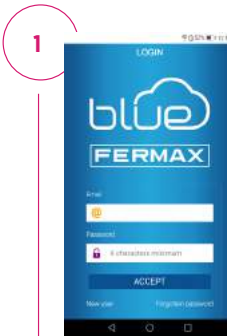
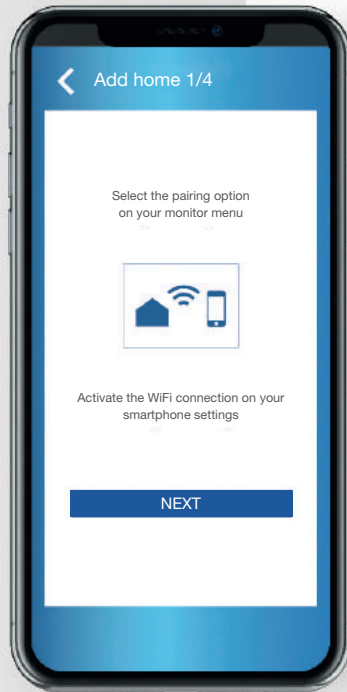

Download the BLUE app on your mobile device and set up a new account.

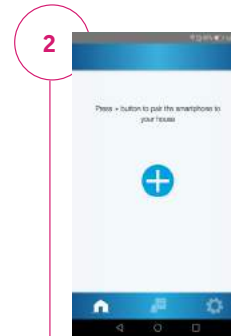

Add your home in the APP.

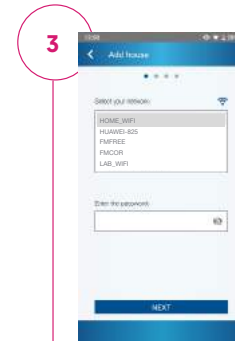

Select the WiFi network that you want to connect the monitor to.

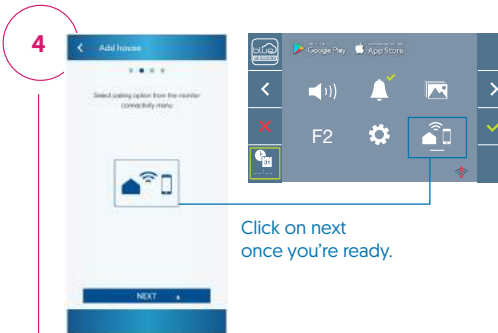

Click on next once you're ready.

Select 'Pairing' from the monitor menu and scan the QR code that will appear on the monitor screen.

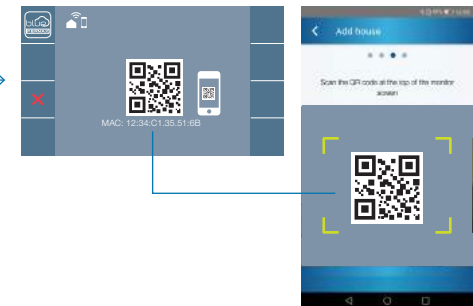

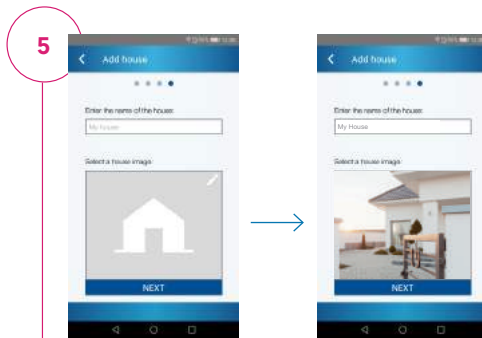

Your home will appear in the app.
You can personalise it with a name and photo.

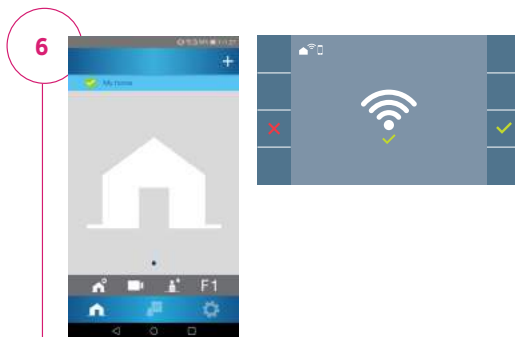

If everything is ok, a green tick will appear on the app. On the monitor, this icon means that we are paired correctly.



If you want to follow the pairing process from a video, scan this code >





Pick up



Reject / Hang up



Door opening



Using the APP

Receiving calls and opening the door from your mobile device

When someone calls the home video door entry system, the BLUE app will activate and show you the call directly on the screen. If your mobile device uses iOS and the app is closed, you'll get a push notification. The audio will not be connected when the call is received, only the video will be available.

From then on, **the way it works is similar to your video door entry system: You can answer and talk, reject the call or open the door.**

If your mobile device is not within reach and you pick up the phone, the conversation will be in hands-free mode. The handset will activate if you bring it to your ear and the video will be turned off.

If you have several mobile devices paired with the video door entry system, the first one that is picked up will answer the call. The other paired mobile devices will stop ringing and the call will appear in the register.

If, on the other hand, you reject it, the call will continue ringing both in the home and on the other mobile devices.

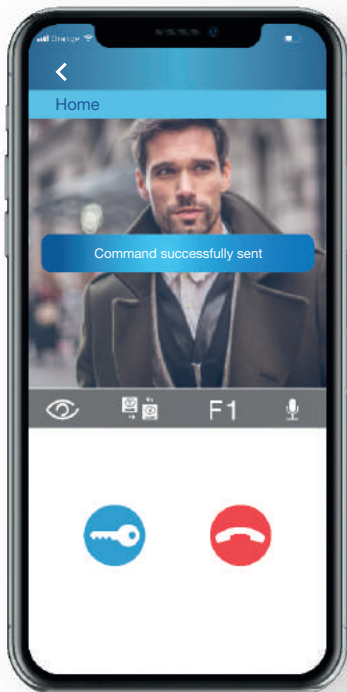

 Door opening

Opening the door remotely is as simple as pressing the key icon on BLUE

 For **security** reasons, your mobile device will ask you to authorise the door opening with the security method you have configured: **PIN, fingerprint, pattern or face recognition.**



VEO
by FERMAX



VEO XS
by FERMAX



CONNECTIVITY
FOR EVERYONE



REF. 9446 DUOX VEO WiFi MONITOR

REF. 9449 DUOX VEO-XS WiFi MONITOR

REF. 9459 DUOX VEO-XS WiFi MONITOR WITH INDUCTIVE LOOP



REF. 3443 VEO TELEPHONE HANDSET WITH INDUCTIVE LOOP



REF. 9447 VEO/VEO-XS DUOX CONNECTOR

REF. 9410 VEO MONITOR DESKTOP SUPPORT

REF. 9420 VEO-XS MONITOR DESKTOP SUPPORT

REF. 3388 UNIVERSAL FRAME 120X240 (Only for VEO-XS)

REF. 3389 LARGE UNIVERSAL FRAME 210X240

REF. 9441 1/W DUOX VEO WiFi KIT

REF. 9451 1/W DUOX VEO-XS WiFi KIT

If you think about it,
you'll find a thousand reasons to want them.

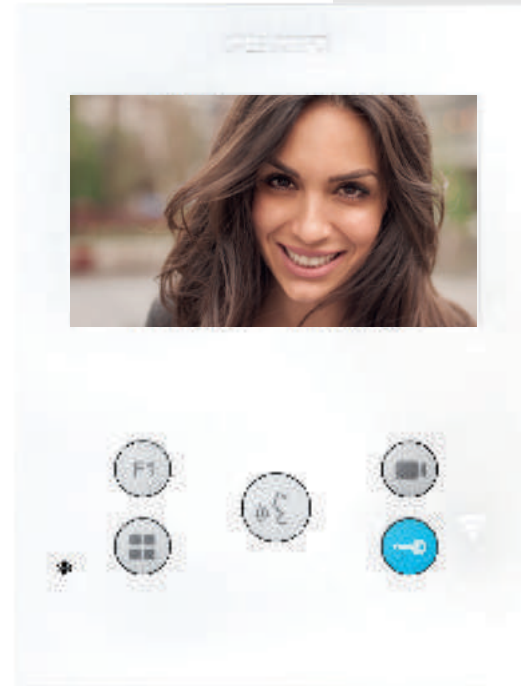

I WANT IT



www.fermax.com

